

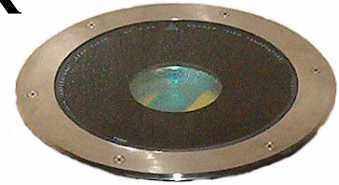

WFP-G-VARIACOLOR

An interactive, color-changing,
in-grade, accent light.



“UNIQUE LIGHTING SOLUTIONS”

ORDERING

| | |
|------------------|--|
| WFP-G-VAR-(watt) | (watt) = specified Wattage |
| -MH | 35W Metal halide lamp |
| -CRI | Color Rendering Index* |
| -CCT | Correlated Color Temperature* |
| -CWA | Core and Coil Ballast |
| -ELEC | Electronic Ballast |
| -CF | Custom Finish* |
| -XXX | Ballast Voltage* |
| -SNXX | Snoot in inches (note internal color)* |
| -VS | Cutoff Visor |
| -RBB | Remote Ballast Box |

* Consult Factory

DIMENSIONS

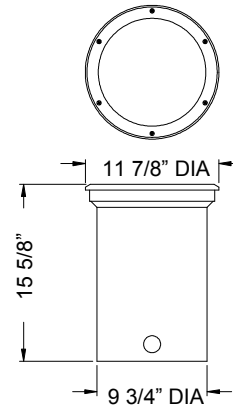

- Internal controller or interactive DMX controllers available.

- CMY system.

EXAMPLE: WFP-G-VAR-35-MH-85-3500-CWA-120-PVC

SPECIFICATIONS

Housing– High grade, cast aluminum with a stainless steel ring for complete seal against moisture.

Lamps– 70W to 150W HID. Please contact factory for lamp selections not found on ordering selector.

Lens– Clear, 1/2" thick, tempered glass lens.

Color– CMY filter with DMX stand alone, controllers available for even more color sequencing.

Reflector– High reflectance, spun aluminum for maximum control of beam. The reflector has an adjustable socket assembly to adjust the beam angle ± 15 degrees for field aiming.

Finish– High quality, outdoor, polyester, powder coat.

Ballast– High power factor, core and coil ballast can be either remote or integrally mounted on yoke. Electronic ballasts are also available.

Mounting– Ground mount. A heavy duty PVC sleeve is also available (as shown above).

Weight– Approximately 29 lbs (with PVC sleeve).

Labels– NRTL Listed for wet locations.